

TECHNICAL BULLETIN No. 021-2008**11-11-2008****Model: RSV 1000 My 06 – Tuono My 07****Subject: New clutch spring washers**

Dear Dealer,

from engine No. **8176297** on, new clutch spring washers have been introduced in models specified above in order to reduce the effort necessary to disengage the clutch.

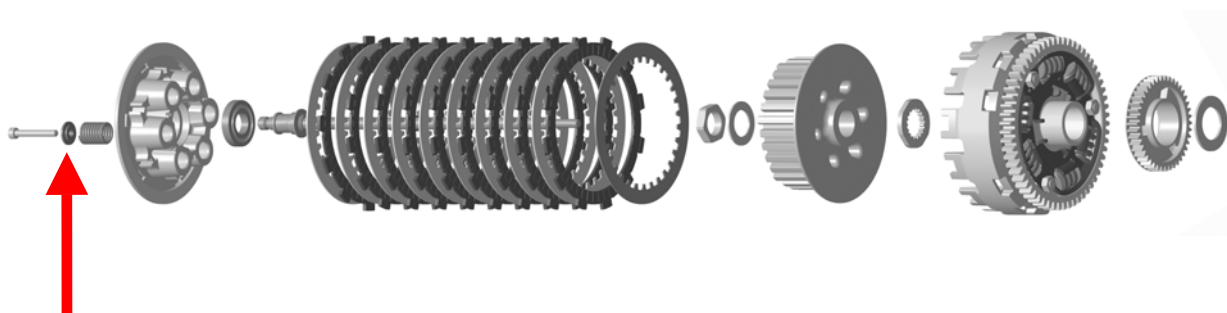

The new washers can be identified by increased thickness and the presence of a groove.

**New version - code AP0627535****Old version - code AP0627530**



WARNING: the new clutch spring washers are installed only with clutch discs code AP0659800, fitted to RSV as from the 2006 model and to Tuono as from the 2007 model. In order to identify with certainty the codes to be used, refer to the following table.

MODEL	WASHER series	CLUTCH DISC series	ALTERNATIVE
RSV 1000 '04	AP0627530	AP8106867	AP0627535 + AP0659800
RSV 1000 '06 engine < 8176296 Tuono 1000 '07 engine < 8176296	AP0627530	AP0659800	AP0627535
RSV 1000 '06 engine > 8176297 Tuono 1000 '07 engine > 8176297	AP0627535	AP0659800	
All other V990 engines	AP0627530	AP8106867	AP0627535 + AP0659800

Best regards

Piaggio & C S.p.A.
Brand Aprilia
Technical service